

Ranger Tugs R-29

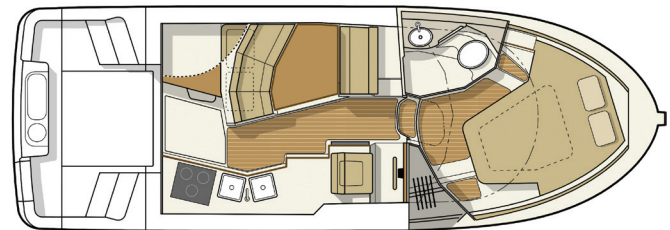

- ◆ Pilot House door at helm for easy access to the bow
- ◆ Bow and stern thruster for easy maneuverability
- ◆ Mase 4KW generator and Garmin electronics standard
- ◆ Two staterooms sleeps six
- ◆ Forward stateroom with an island berth, separate head and shower
- ◆ Midship stateroom with double berth and bi-fold privacy door
- ◆ 15 knot cruise speed
- ◆ Trailerable

Specifications

| | | | | | |
|--------------------|-----------|---------|--------------------------------|-----------|----------|
| Length Overall | 29' 0" | 8.9 m | Water Capacity | 70 gals. | 265 ltrs |
| Length w/swim step | 33' 0" | 10.06 m | Holding tank Capacity | 40 gals. | 151 ltrs |
| Beam | 10' 0" | 3.05 m | Fuel Capacity (Main tank) | 120 gals. | 454 ltrs |
| Draft | 28" | .71 m | Fuel Capacity (Auxiliary tank) | 30 gals | 114 ltrs |
| Displacement | 9,250 lbs | 4196 kg | Height on Trailer | 13' 2" | 4.03 m |



Ranger Tugs 25802 Pacific Highway South Kent, Washington 98032
 Phone 253-839-5213 Fax 253-839-5218 www.rangertugs.com

Ranger Tugs R-29

Standard Equipment

Yanmar 260 HP 6BY
Anchor locker, SS self launching bow roller
Batteries (4) with charging relays, crossover
Battery charger, 30 amp, 115V, 3 Bank
Bilge pump, (2) 12V automatic, 1000 gph
Bonded 12V electrical system
Cabin Heater
Cable outlets, dockside TV
CO Monitor (2)
Cockpit convenience center, sink and cooler
Companion seat, double forward facing
Compass
Cooktop electric (3) burner
Courtesy lights, cockpit entry step, side and bow
Dinette, salon, converts to bed, sleeps 2
Electrical Panels AC/DC
Enclosed head w/separate corian shower and sink
Engine control panel w/full instrumentation
Entertainment ctr, Master stateroom dvd, cd , 19" Tv
Fiberglass cockpit liner, self bailing w/non-skid
Forward deck hatch, opening, translucent
Generator, Mase 4 KW
Hatches (5), pilothouse roof, opening with screens
Horns dual trumpet
Hot water tank, 6 Gallon
Marine head, electric, holding tank, deck pump out
Mast, 50" stainless steel, hinged
Midship stateroom, double berth, privacy door
Navigation lights w/light boards
Navigation package, Garmin 5215, 4 KW HD radar dome, gps ant and transducer
Outlets 110V (4)
Oven, microwave/ convection combo
Pilothouse door, stbd side, sliding, locking
Portlights , brass, opening with hooks
Power outlet, 12v port and stbd, fwd state room
Refrigerator, 12v DC
Rod holders
Rudder, bronze
Seawater strainers
Shorepower 30 amp/115v, w50' cord
Single-lever engine control, electric throttle/shift
Sinks (4), water system w/demand pump, hot and cold
Sport rack with stainless steel ladder
Spotlight, 6" remote control

Stereo, salon, AM-FM w/CD , 4-speakers, MP3 jack
Storage lockers, cabin, w/teak louvered doors
Swim platform , fiberglass with 4 rung ladder and fenders
Wine cooler, 6 bottle AC/ DC
Teak and holly cabin sole
Teak and holly carpet in cockpit
Thrusters, bow and stern
Transom door
Trim tabs, hydraulic
VHF radio
Visor/drip rails, fwd and side windows
Washdown, raw water
Water tank level monitor
Windlass 12V Lewmar 1000 SS (helm and bow controls)
Windshield wipers (4)

Available Factory Options

Aft bimini top with boot
Aft side-enclosures, clear Strato-glass
(Aft bimini required)
Air Conditioning w/ Rev cycle heat 16,000 btu
main salon, 10,000 btu master stateroom \$6,980
Anchor Pkg, 22# Anchor, 50' Chain, 200' line \$540
Bar-b-que, electric for cockpit convenience center \$1,200
Diesel Heater, 14,000 BTU forced air furnace \$5,450
International option, 240V shorepower
and fire suppression \$860
Macerator discharge w/ Y-valve \$480

Special Introductory pricing from

\$239,937*

**Options, freight & taxes extra*

www.rangertugs.com

Prices, specifications, equipment & options may change without notice